

PIN CORNER DEVELOPMENT

7500 CORTEZ ROAD, BRADENTON, FL 34210



PROPERTY INFORMATION

- Three-tenant redevelopment at a major signalized intersection with 50,000 +/- combined daily traffic
- Drive thru end cap with stacking for up to 15 vehicles
- Pin corner end cap has excellent visibility and potential patio seating for a restaurant
- Located in the Tampa-St. Petersburg DMA, Bradenton has seen an increase of more than 13% since 2010

DEMOGRAPHICS

	5 MINUTES	10 MINUTES	15 MINUTES
Population 2022	30,184	102,837	170,130
Projected Population 2027	32,056	109,879	183,659
Average Household Income	\$68,624	\$70,330	\$67,626

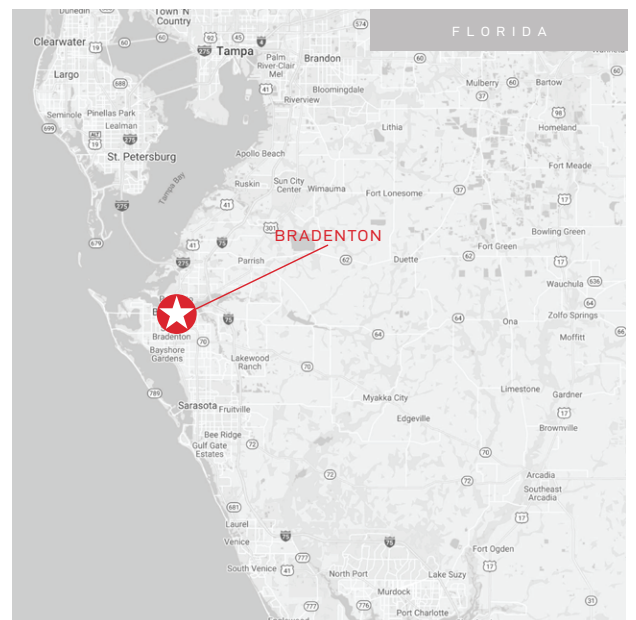

CONTACT

Nick Addison c / 404.256.9100 e / nickaddison@staffordprop.com

STAFFORD

Building on the Past. Developing for the Future.

PIN CORNER DEVELOPMENT

7500 CORTEZ ROAD, BRADENTON, FL 34210

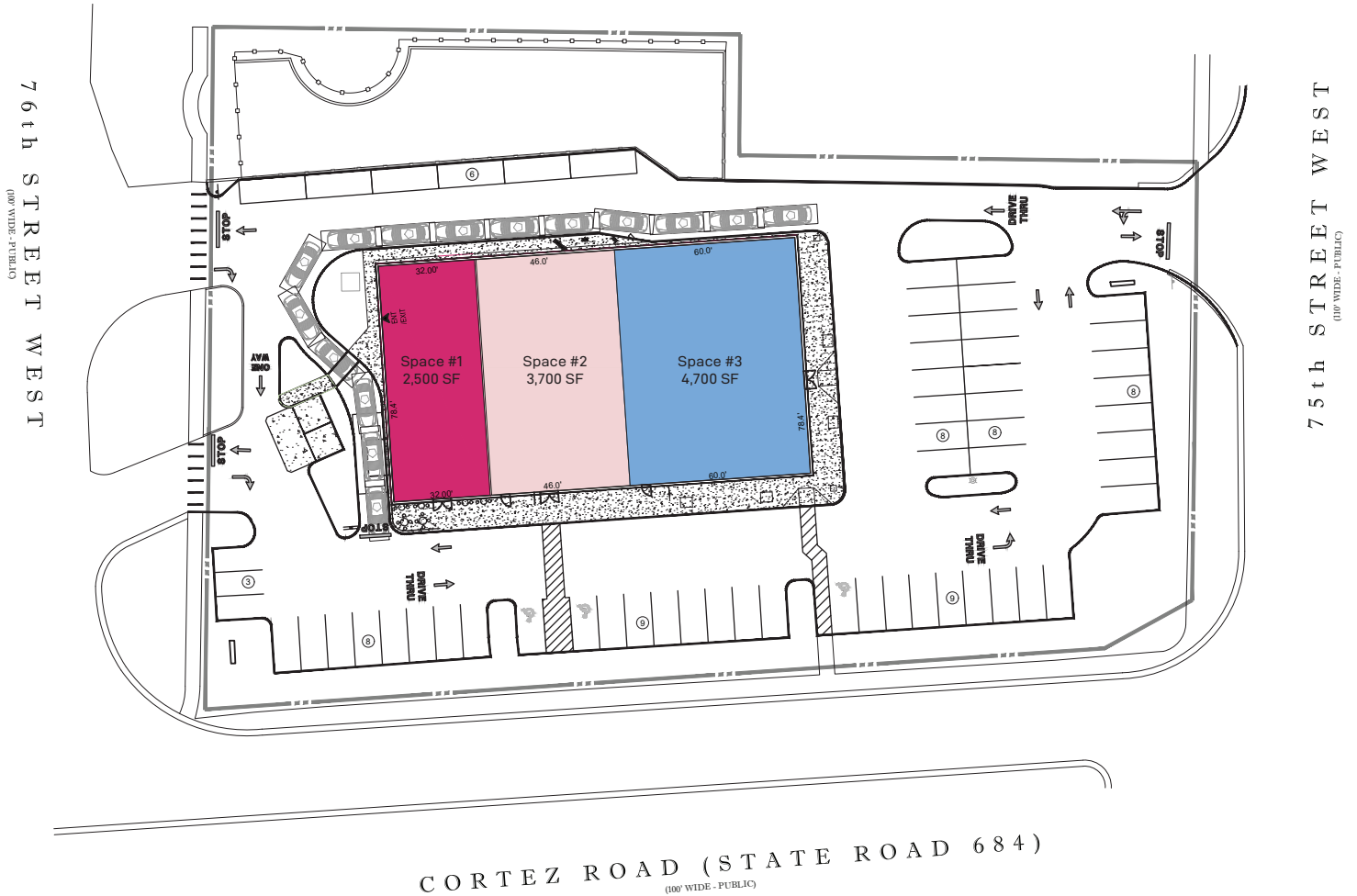

CONTACT

Nick Addison c / 404.256.9100 e / nickaddison@staffordprop.com

STAFFORD

Building on the Past. Developing for the Future.

PIN CORNER DEVELOPMENT

7500 CORTEZ ROAD, BRADENTON, FL 34210



CONTACT

Nick Addison c / 404.256.9100 e / nickaddison@staffordprop.com

STAFFORD

Building on the Past. Developing for the Future.